

# SITE PLAN & LEASING

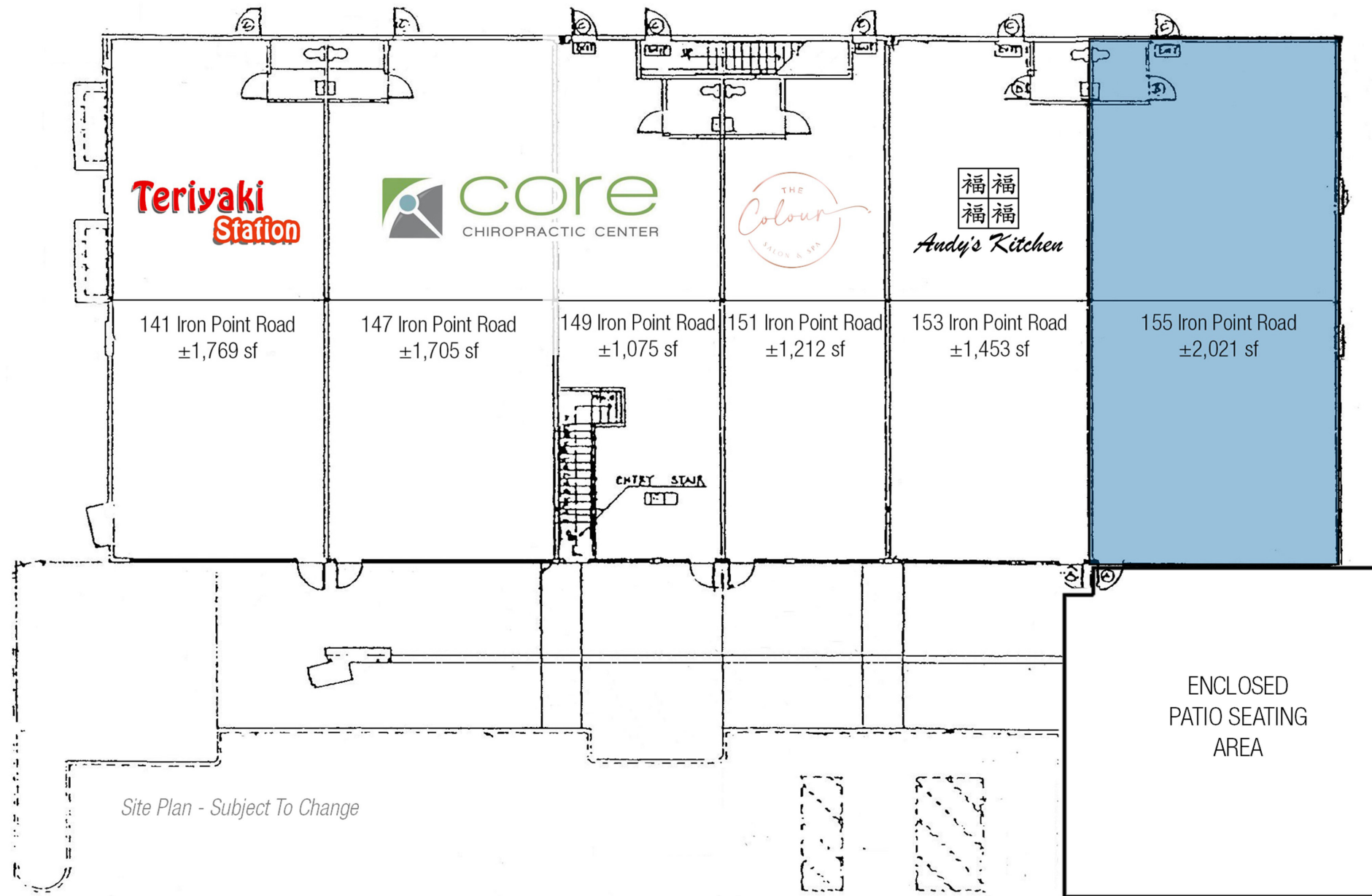

SUITE	TENANT	SQUARE FEET
141	Teriyaki Station	1,769
147	Core Chiropractic Center	1,075
149	Core Chiropractic Center	1,075
151	The Colour Chemistry Salon	1,212
153	Andy's Kitchen	1,453
155	AVAILABLE	2,021



Gary B. Gallelli, Broker  
CA DRE #00811881

## GALLELLI RETAIL TEAM

**MATT GOLDSTEIN**  
Vice President  
CA DRE #01886233  
mgoldstein@gallellire.com

## CONTACT US

**GALLELLI REAL ESTATE**  
3005 Douglas Boulevard, Suite 200  
Roseville, CA 95661  
(916) 772-1700 | gallellire.com