

2ND GENERATION RESTAURANT SPACE AVAILABLE FOR LEASE

# NATOMA STATION

141 - 155 IRON POINT ROAD - FOLSOM, CA



**MATT GOLDSTEIN**  
Vice President  
CA DRE #01886233  
mgoldstein@gallellire.com



**GALLELLI REAL ESTATE**  
(916) 772-1700  
www.GallellIRE.com



SQUARE FEET  
±9,235

NOTABLE NEARBY TRAFFIC GENERATORS



# SEE YOURSELF HERE.

Natoma Station is located at the southwest quadrant of Folsom Boulevard and Iron Point Road in Folsom, California.

The subject property at 155 Iron Point Road is part of a ±9,235 square foot high profile strip center that is visible to more than 36,000 cars per day travelling the intersection.

In addition, Natoma Station is situated at the primary access point of the Folsom Premium Outlets, which is ±857,893 square feet of retail space.

Notable traffic generators within close proximity include Intel, Cal ISO, Kaiser Permanente, Folsom Auto Mall and Folsom High School.

Traffic generators within the immediate vicinity are Century Folsom 14, Larkspur Landing (84-rooms), Hilton Garden Inn (100-rooms), Taco Bell, Burger King, and Chili's.

	1-Mile	3-Mile	5-Mile
2022 Total Population	3,154	59,863	164,264
2022 Daytime Population	6,971	67,231	175,192
2022 Total Employees	5,376	33,173	77,787
2022 Total Households	1,176	22,752	61,068
2022 Average Household Income	\$153,429	\$132,499	\$135,864
	Folsom Boulevard (at Natoma Station Drive)	Iron Point Road (at Folsom Boulevard)	US Highway 50 (at Folsom Boulevard)
Traffic Counts	34,082	12,532	94,000

# SITE PLAN & LEASING

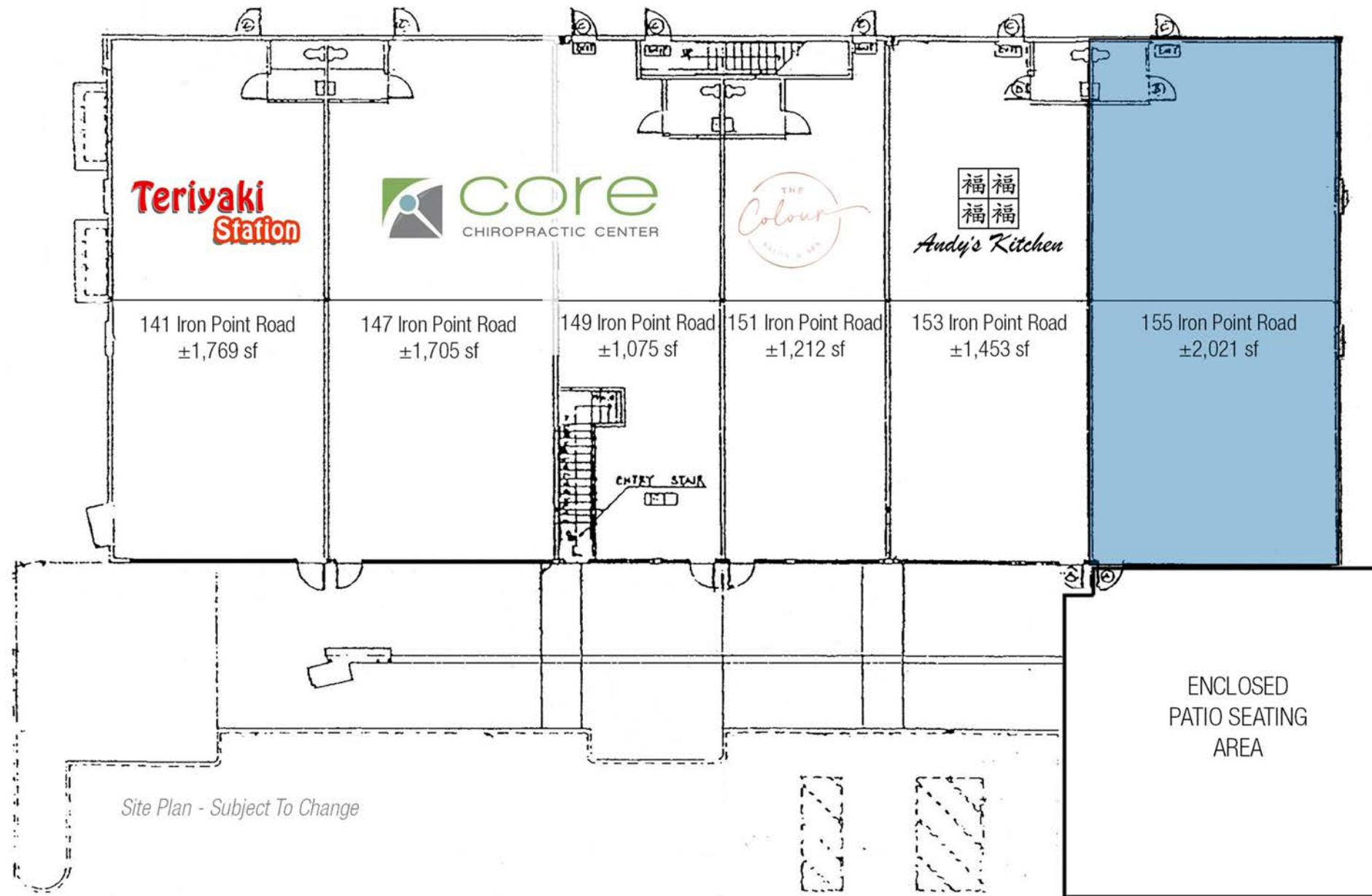

SUITE	TENANT	SQUARE FEET
141	Teriyaki Station	1,769
147	Core Chiropractic Center	1,075
149	Core Chiropractic Center	1,075
151	The Colour Chemistry Salon	1,212
153	Andy's Kitchen	1,453
155	AVAILABLE	2,021



Gary B. Gallelli, Broker  
CA DRE #00811881

## GALLELLI RETAIL TEAM

**MATT GOLDSTEIN**  
Vice President  
CA DRE #01886233  
mgoldstein@gallellire.com

## CONTACT US

**GALLELLI REAL ESTATE**  
3005 Douglas Boulevard, Suite 200  
Roseville, CA 95661  
(916) 772-1700 | gallellire.com

